

Anhui Royal Forklift CO., LTD.

www.ryforklift.com

Add / No.18, Xingye Road, Baochanshan Industrial Park, Ma'anshan City, Anhui Province, P.R. China 238100
 TEL / (86)512-65916195 FAX / (86)512-65915205 Email / info@ryforklift.com

*All Rights Reserved by Royal Forklift.



HAND PALLET TRUCK M25-M30

MOST STANDARD AND POPULAR MODEL WITH CAPACITY 2500 - 3000KGS.

- Ideal for all variety of manual transport tasks over short distances in stores and warehouse as well as factory plants.
- Top class range of hand pallet trucks with excellent designs.
- Reliable, robust and durable due to its extremely strong high quality steel profile, perfect powder coating and painting quality which is resistant to chip and corrosion.
- The lifting system with overloading protection valve to ensure the safe operation 210 degree steering arc with small turning radius.

Hand Pallet Truck					
1KG=2.2LB 1INCH=25.4MM					
Item/Type		M25		M30	
Capacity Q	kg	2500		3000	
Min.fork height	h13(mm)	85	75	85	75
Max.fork height	h3(mm)	200	190	200	190
Steering wheel	mm	Φ200×50	Φ180×50	Φ200×50	Φ180×50
Load roller Single	mm	Φ80×93	Φ74×93	Φ80×93	Φ74×93
Load roller Tandem	mm	Φ80×70	Φ74×70	Φ80×70	Φ74×70
Size of fork	mm	160×50	160×50	160×60	160×60
Width overall forks	b5(mm)	450/520/540/685			
Fork length	L(mm)	1100/1150/1220			
Aisle width for pallets 1000×1200 crossways	Ast(mm)	1733/1803			
Aisle width for pallets 800×1200 lengthways	Ast(mm)	1733/1803			
weight	kg	65-85			



Professional

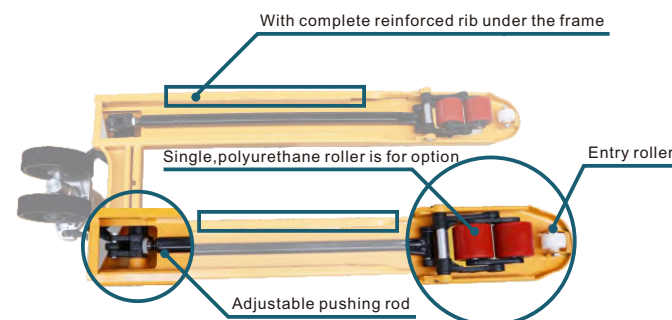
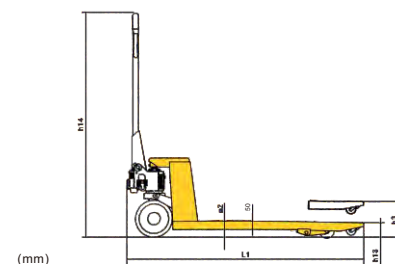
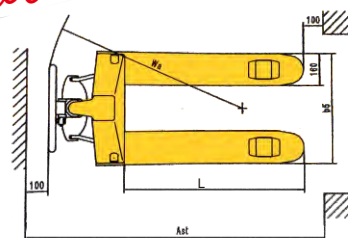

HAND PALLET TRUCK M20S

ECONOMIC DESIGN PALLET TRUCK MODEL WITH CAPACITY 2000KGS, MAKE IT IDEALLY SUITED FOR A WIDE RANGE WORKING REQUEST.

- Economic but reliable, smart and easy to operate.
- Ergonomically designed handle, with three position lever for lifting, transporting and lowering purposes.
- Welding pump with leaking-proof design.
- Reliable, robust and durable due to its extremely strong high quality steel profile, perfect powder coating and painting quality which is resistant to chip and corrosion.
- The lifting system with overloading protection valve to ensure the safe operation 190 degree steering arc with small turning radius.

Economic but reliable		
1KG=2.2LB 1INCH=25.4MM		
Item/Type		M20S
Capacity Q	kg	2000
Min.fork height	h13(mm)	75
Max.fork height	h3(mm)	190
Steering wheel	mm	Φ180×50
Load roller Single	mm	Φ73×80
Load roller Tandem	mm	Φ73×55
Size of fork	e+s(mm)	150×50
Width overall fork	b5(mm)	550
Fork length	L(mm)	1100/1150/1220
Aisle width for pallets 1000×1200 crossways	Ast(mm)	1720/1790
Aisle width for pallets 800×1200 lengthways	Ast(mm)	1720/1790
weight	kg	55-65



Economy

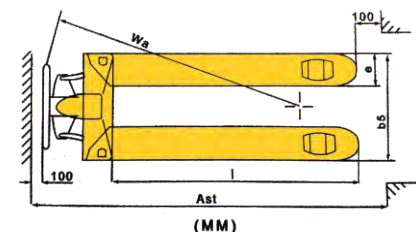
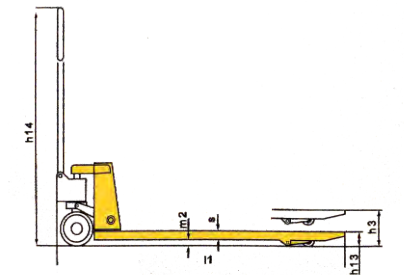

OPTION:

- Nylon wheel, Polyurethane wheel, rubber wheel
- Single fork roller, tandem fork roller
- Pump color: black painting, silver galvanized
- Brake system
- Galvanized pallet truck or stainless steel pallet truck available

Remark: Special size for width and length can be made according to customer's request.

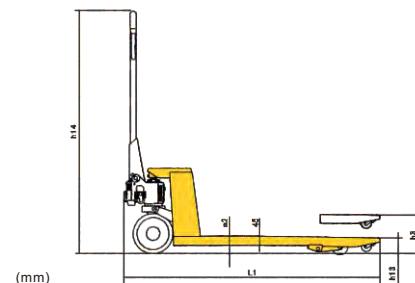

Hand Pallet Truck				1KG=2.2LB 1INCH=25.4MM
Item/Type		M35		M50
Capacity Q	kg	3500		5000
Min.fork height h	mm	85	75	85
Max.fork height h1	mm	200	190	200
Steering wheel	mm	Φ200x50	Φ180x50	Φ180x50
Load roller Single	mm	Φ80x93	Φ74x93	-
Load roller Tandem	mm	Φ80x70	Φ74x70	Φ80x70
Size of fork e*s	mm	160x60	160x60	160x60
Width overall forks B	mm	450/520/550/685	450/520/550/685	685
Fork length l	mm	1100/1150/1220	1100/1150/1220	1100/1150/1220
weight	kg	80-100	80-100	132-142

HIGH LIFT SCISSOR TRUCK

- Supporting legs and adjustable stabilizers extended to the floor automatically when the forks reach a height of 420mm, to ensure the max. stability.
- The descending speed always keeps same regardless the truck with or without loading, which prevents cargo damage from last descending.
- Different handle for option.
- Capacity: 1000kg/1500kg.



single piston



double piston

		single piston	double piston	
Model		MX-10A	MX-10B	MX15B
Capacity	kg	1000	1000	1500
Min.fork height	mm	85	85	85
Max.fork height	mm	800	800	800
Fork width	mm	540/680	520/680	520/680
Fork length	mm	1150	1140	1100
Net weight	kg	128/133	105/112	118/125
Packing 4pcs/pallet	cm	214x62x111/214x76x111	193x58x72/193x74x72	193x58x77/193x74x77
20' quantity	pcs	72	120/96	120/96



GALVANIZED
PALLET TRUCK



STAINLESS STEEL
PALLET TRUCK

Widely used in the fields of meat and other food industry;
Could work in low temperature conditions, e.g. to deliver goods into and out of freezers or coolers.



PALLET TRUCK
WITH BRAKE SYSTEM

Pallet truck with brake system can conveniently cease the truck and navigate ramps.



LOW-PROFILE
PALLET TRUCK

Special size pallet truck can be produced as per customer's request



ØPU Wheel —
Quiet and durable,
ideal for delicate
floors with hard
wearing and non-
marking property.



ØNylon Wheel —
Low drag efforts,
high resistance to
chemicals, non-
marking, ideal for
smooth level floors.



ØRubber Wheel —
Best choice for quiet
and durable demands,
ideal for smooth and
rough floors.

Hydraulic Lift Table

- High quality hydraulic ensure reliable long life
- Designed as per CE standard
- With protection bracket and brakes on rear wheel
- With overload protection



Model (single sissor)		MT-15A	MT-30A	MT-50A	MT-100A	MT-150A
Load capacity/rated load	kg	150	300	500	1000	1500
Max.lift height	h12 (mm)	740	900	900	1000	1000
Min.height of table	h13 (mm)	225	340	340	380	420
Lifting height	h3 (mm)	515	560	560	620	580
Table size	lxb5xs(mm)	740*450*35	855*500*50	855*500*50	1000*510*55	1220*610*60
Foot pedal cycles to max height		≤25	≤32	≤45	≤55	≤70
Service weight	kg	44	82	87	115	135
Carton size	mm	860*485*300	985*510*350	985*510*350	1170*610*420	1420*725*420

Hydraulic Lift Table

High quality hydraulic ensure reliable long life

Designed as per CE standard

With overload protection

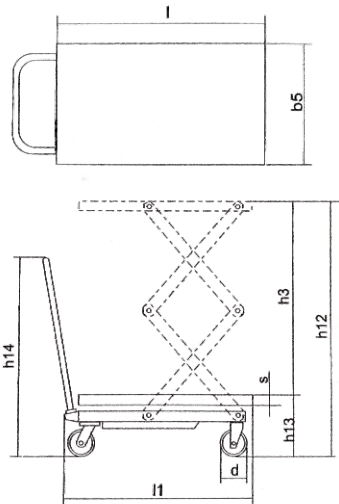

Hydraulic Lift Table

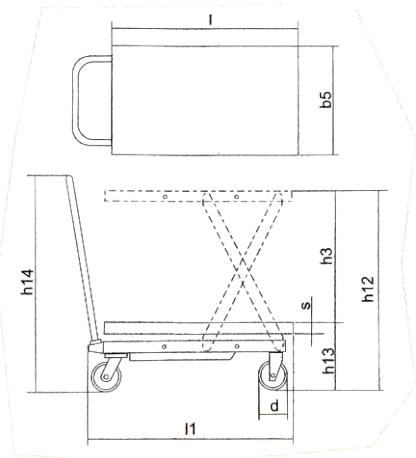

Model (single sissor)		MT-15B	MT-35B	MT-80B
Load capacity/rated load	kg	150	350	800
Max.lift height	h12 (mm)	1100	1300	1500
Min.height of table	h13 (mm)	302	350	475
Lifting height	h3 (mm)	798	950	1025
Table size	lxb5xs(mm)	700*450*35	910*500*52	1220*610*60
Foot pedal cycles to max height		≤30	≤60	≤70
Service weight	kg	64	105	172
Carton size	mm	860*485*300	985*510*350	1370*645*470

HAND STACKER

- High quality mast steel ensures rigidity, durability.
- High effiperating lighter, more comfortable.
- Lifting spped keeps smooth regardciency pump ,oless of loading weight, which is safe to use.
- The stacker can be lifted by handle or foot pedal.
- Hand control valve precises control convenience.
- Integral pump, which prevents loosening, leak- proof.
- Set the active safety valve to prevent overloading of use.
- Maitenance-free design, ensures security, reduces service cost.
- Fork styles as below are for options.

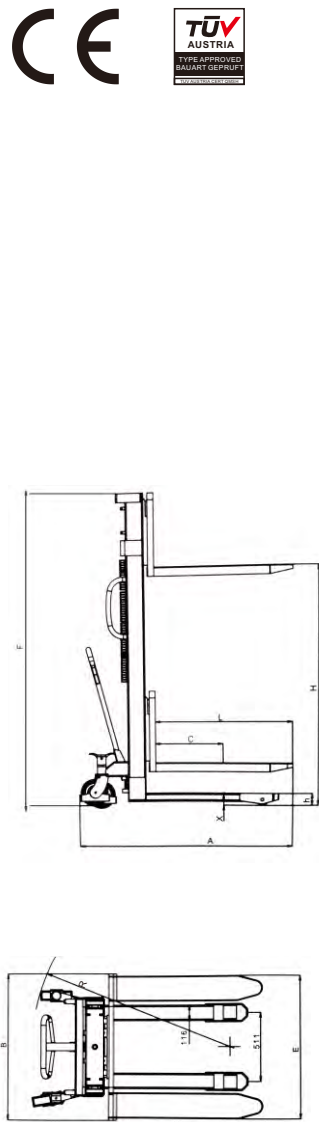

HAND STACKER OF STRADDLE LEGS



- C-steel ensures high capacity,rigidity.
- Oil leaking-proof pump,2 years warranty.
- 180mm bigsteering wheel desing

• Option with adjustable wide legs

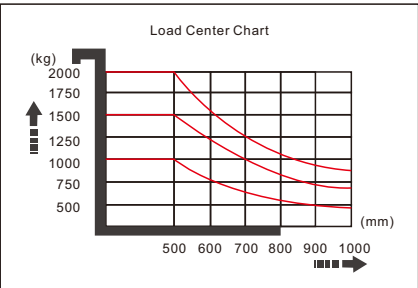
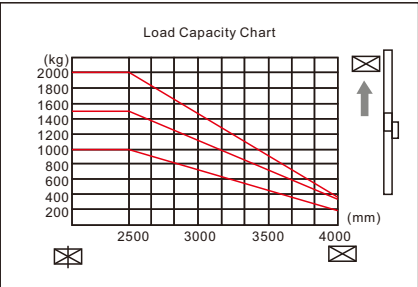

Item	Model		MS-10A	MS-15A	MS-20A
Characteristic	Capacity	Q(kg)	1000	1500	2000
	Load center	C(mm)	500	400	400
Tyre size	Front wheel	mm	Φ 80×70	Φ 80×70	Φ 80×70
	Rear wheel	mm	Φ 180×50	Φ 180×50	Φ 180×50
Size	Lifting height	H(mm)	1600/2500/3000	1600/2500/3000	1600/2500/3000
	Fork lowered height	h(mm)	90	90	90
	Fork length	L(mm)	900-1150	900-1150	900-1150
	Fork width(fixed/adjustableforks)	E(mm)	660/200-930	660/240-930	660/240-930
	Overall length	A(mm)	1280	1280	1280
	Overall width(fixed/adjustableforks)	B(mm)	700/980	700/980	700/980
	Most lowered height	F(mm)	2080/1830/2080	2080/1830/2080	2080/1830/2080
	Ground clearance	X(mm)	30	30	30
	Min. turning radius	R(mm)	1200	1200	1200
Weight	Net Weight	kg	250-316	250-316	250-316
Performance	Lifting speed with/without load	mm/s	20/22	20/22	20/22
	Falling speed with/without load	mm/s	143/53	143/53	143/53



MS SERIES
WITH ADJUSTABLE FORKS



MS SERIES
WITH STRADDLE LEGS

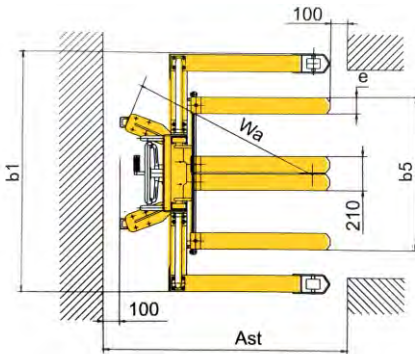
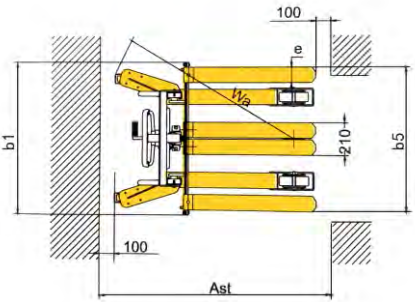
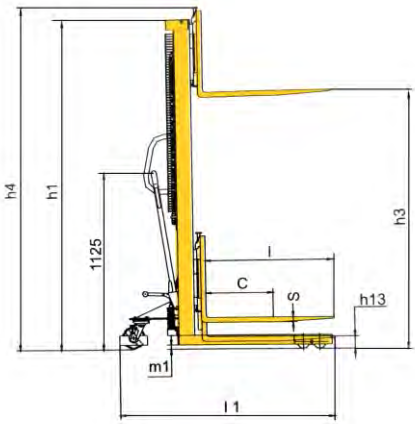

Model		MS-500B	MS-1000B	MS-1500B	MS-500BS	MS-1000BS
Load capacity/rated load	Q(kg)	500	1000	1500	500	1000
Load centre distance	c(mm)	500	500	500	500	500
Fork height, lowered	h13(mm)	90	90	90	70	70
Height, mast lowered	h1(mm)	2000	2085/1840	2090	2000	2050
Max. lift height	h3(mm)	1600	1600/2500	1600	1600	1600
Height, mast extended	h4(mm)	2010	2165/2925	2150	2100	2155
Overall length	l1(mm)	1380/1640	1380/1640	1380/1640	1340/1600	1300/1560
Overall width	b1(mm)	805	1000/750	1000	1500	1450
Fork dimensions	s/e/l(mm)	48/100/800(1060)	30/100/800(1060)		48/100/800(1060)	30/100/800(1060)
Width overall forks	b5(mm)	200-745	200-950/700	200-950	745	950
Round clearance, laden, below mast	m1(mm)	20	25	25	25	25
Aisle width for pallets 1000×1200 crossways	Ast(mm)	1915	1915	1915	1975	1975
Aisle width for pallets 800×1200 lengthways	Ast(mm)	1910	1910	1910	1915	1915
Turning radius	Wa(mm)	1235	1235	1235	1200	1200
Lift speed, laden/unladen	mm/time	25	25	21	25	25
Lowering speed, laden/unladen	mm/time	Manual control	Manual control	Manual control	Manual control	Manual control
Service weight	kg	161	250/316	280	217	336

Standard Semi-electric Stacker

- Compact design with strong European steel construction.
- Simple and convenient lifting operating system.
- Light and easy manual steering system, equipped with a parking brake.
- Smooth control of precise lifting and lowering.
- Special design are available according to customers' requirements.



Model		HS-S
LOAD CAPACITY	Q(kg)	1000/1500/2000
LOAD CENTER	c(mm)	500
WHEEL BASE	Y(mm)	1145
WEIGHT (WITH BATTERY)	kg	410/480/510
WHEEL SIZE, FRONT	(mm)	Φ80x50
WHEEL SIZE, REAR	(mm)	Φ80x93
HEIGHT, MAST LOWERED	h1(mm)	2085/1885/2085
LIFTING HEIGHT	h3(mm)	1600/2500/3000/3300/3500
MAST HEIGHT AT MAX. LIFTING HEIGHT	h4(mm)	2085/2910/3410
LOWERED FORK HEIGHT	h13(mm)	70
OVERALL LENGTH	l1(mm)	1505
OVERALL WIDTH	b1(mm)	1080-1420
FORK LENGTH	l(mm)	900
FORK WIDTH	b5(mm)	240-660
MAST GROUND CLEARANCE	m1(mm)	28
AISLE WIDTH FOR PALLET 1000x1200 (1200 CROSSWAYS)	Ast(mm)	1705
AISLE WIDTH FOR PALLET 800x1200 (1200 LENGTHWAYS)	Ast(mm)	1755
TURNING RADIUS	Wa(mm)	1750
LIFTING SPEED, LADEN/UNLADEN	m/s	0.08/0.1
LOWER SPEED, LADEN/UNLADEN	m/s	MANUAL
LIFTING MOTOR POWER	kW	1.6
BATTERY VOLTAGE/NOMINAL CAPACITY	V/Ah	12/(120/135/150)

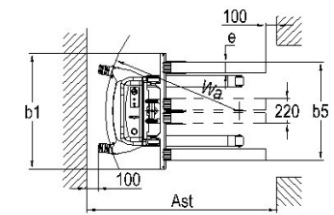
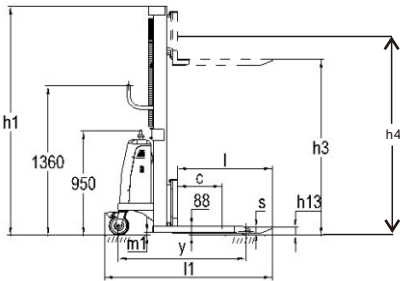

SEMI-ELECTRIC STACKER 1-2T

- Strong mast material ensure high capacity
- Explosion-proof valve in the pump, to avoid rapid decline to protect the operator
- Over-discharge protection device greatly extends battery life
- Lifting speed keeps smooth regardless of loading weight, which is safe to use
- Maintenance-free design, ensures security, reduces service cost
- Three different types of forks are optional

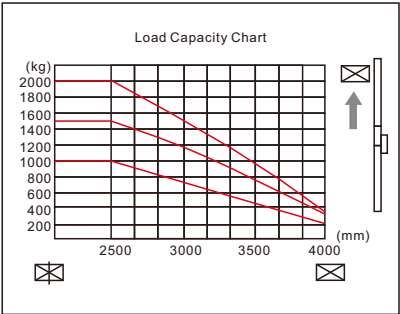

Model		SH
LOAD CAPACITY	Q(kg)	1000/1500/2000
LOAD CENTER	c(mm)	500
WHEEL BASE	Y(mm)	1160/1260/1260
WEIGHT (WITH BATTERY)	kg	380/450/480
WHEEL SIZE, FRONT	(mm)	Φ180x50
WHEEL SIZE, REAR	(mm)	Φ80x93
HEIGHT, MAST LOWERED	h1(mm)	2085/2910/3410
LIFTING HEIGHT	h3(mm)	1600/2500/3000/3300/3500
MAST HEIGHT AT MAX. LIFTING HEIGHT	h4(mm)	2085/2910/3410
LOWERED FORK HEIGHT	h13(mm)	90
OVERALL LENGTH	l1(mm)	1735
OVERALL WIDTH	b1(mm)	800/980/800
FORK LENGTH	l(mm)	900
FORK WIDTH	b5(mm)	660/296-960/240-930
MAST GROUND CLEARANCE	m2(mm)	30
aisle width for pallet 1000x1200 (1200 CROSSWAYS)	Ast(mm)	2288/2368
aisle width for pallet 800x1200 (1200 LENGTHWAYS)	Ast(mm)	2267/2347
TURNING RADIUS	Wa(mm)	1350
LIFTING SPEED, LADEN/UNLADEN	m/s	0.08/0.1
LOWER SPEED, LADEN/UNLADEN	m/s	0.15/0.12
LIFTING MOTOR POWER	kW	1.5/1.6/1.6
BATTERY VOLTAGE/NOMINAL CAPACITY	V/Ah	12/(100/120/135)

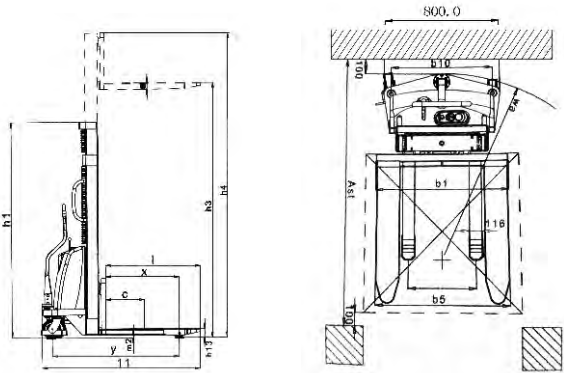

550mm×1150mm



200mm~890mm



290mm~660mm